

# Aalborg EH

## Versatile booster and auxiliary oil heater

The Alfa Laval Aalborg EH is a flow-through electrical heater, ideal for oil heating. Its heat load capacities range from 5 to 233 kW, with design conditions up to 16 bar(g) and 160°C. The standard Aalborg EH can be mounted both vertically and horizontally, but is also available as an outflow suction heater or tank-mounted immersion heater.

The Aalborg EH is approved by all major marine classification societies and is CE/PED approved.



## Design specifications

- **Access points:** Electric power supply terminals (110–690 V AC/DC), the safety thermostat and the optional control thermostat are located on the top hood.
- **Design pressure:** 16 bar(g) [15 bar(g) for EH-40]
- **Design temperature:** 160°C
- **Flanges:** PN 16 DIN 8630, JIS 16K or EN1092-1
- **Installation:** Vertical or horizontal
- **Surface loads:**
  - Lubrication oil: 1 W/cm<sup>2</sup>
  - Heavy fuel oil: 1.4 W/cm<sup>2</sup>
- **Accessories (optional):**
  - Safety valve
  - Drain valve
  - Pressure gauge
  - Thermometer
  - Pt100 sensor

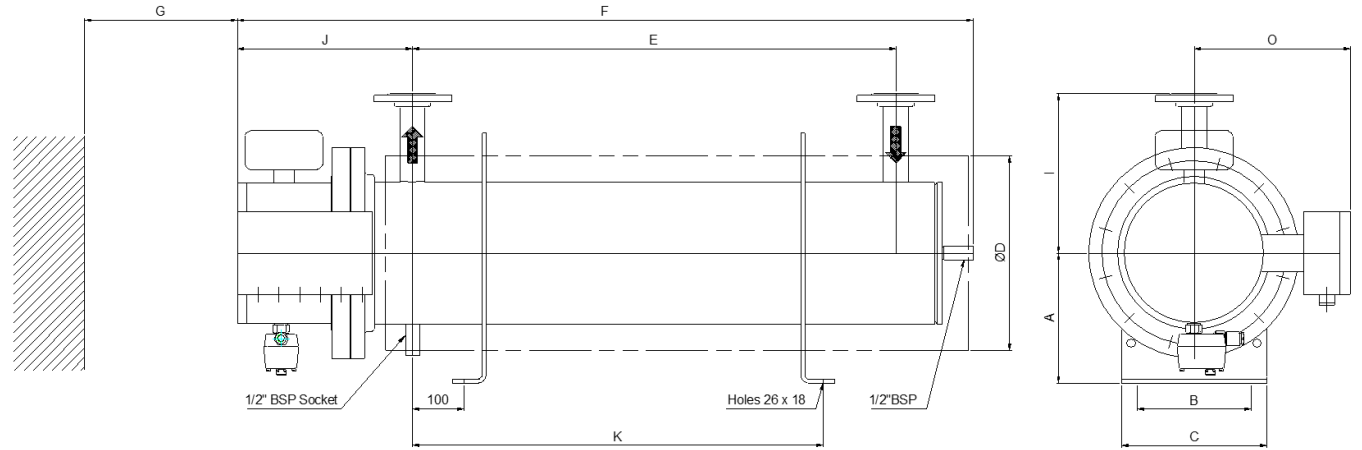

## Standard product range dimensions and weights

Type	EH-15			EH-20			EH-25			
No. of elements	9			18			27	30	27	30
Flange size (DN)	25			25			32			
Element length	600	850	1000	850	850	1000	850	850	1000	1000
A	200			250			250			
B	220			220			220			
C	270			280			280			
E	420	670	820	670	670	820	670	670	820	820
F	891	1141	1291	1137	1137	1287	1142	1142	1292	1292
I	254			280			307			
J	327			322			337			
K	280	530	680	530	530	680	530	530	680	680
ØD incl. insulation	270			325			380			
O	255			275			300			
Net weight (kg)	55	65	71	102	109	112	137	140	163	166

Dimensions in mm. For guidance only. A dimensional drawing will be made upon request.

## Standard product range capacities (kW)

Type	EH-15			EH-20			EH-25			
Lube oil	5	7	8.5	12	14	17	21	23	26	29
Fuel oil	7	10	12	17	20	24	30	33	36	40

Tables continue on the following page

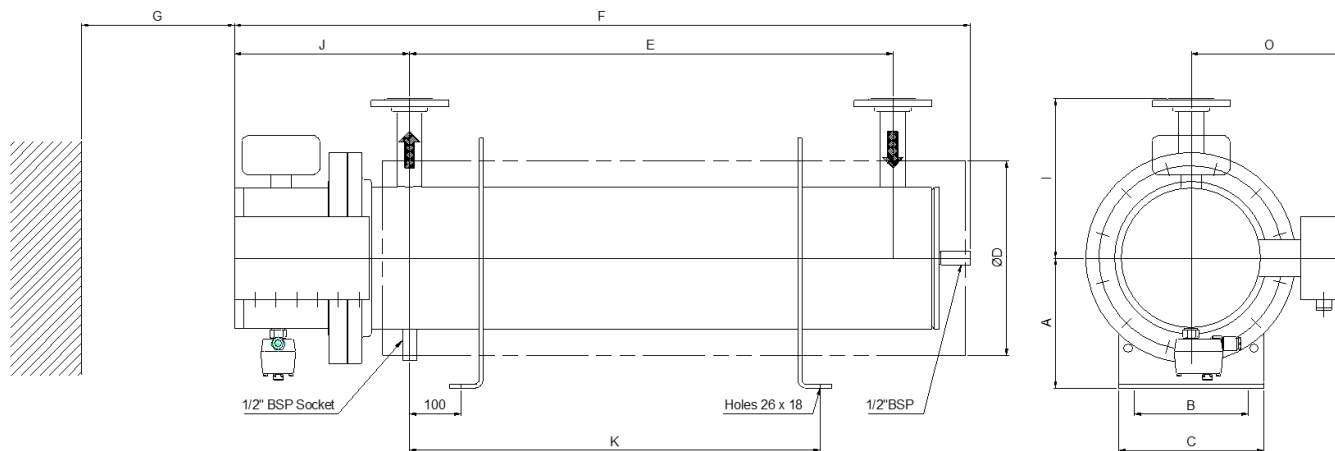

### Standard product range dimensions and weights

Type	EH-30					EH-35					EH-40										
No. of elements	42	39	42	39	42	54	51	54	51	54	66	69	63	66	69	63	66	69	63	66	69
Flange size (DN)	50					50					50										
Element length	850	1000	1000	1200	1200	1000	1200	1200	1500	1500	1500	1500	1800	1800	1800	2150	2150	2150	2400	2400	2400
A	250					250					300										
B	220					300					300										
C	280					350					350										
E	670	820	820	1020	1020	820	1020	1020	1320	1320	1300	1300	1600	1600	1600	2100	2100	2100	2200	2200	2200
F	1152	1302	1302	1502	1502	1309	1509	1509	1809	1809	1814	1814	2114	2114	2114	2590	2590	2590	2840	2840	2840
I	332					348					373										
J	342					347					363										
K	530	680	980	1020	1020	680	880	880	1180	1180	1160	1160	1460	1460	1460	1810	1810	1810	1960	1960	1960
ØD incl. insulation	425					460					510										
O	335					380					400										
Net weight (kg)	206	225	228	254	254	294	327	331	381	386	486	495	555	560	565	745	745	745	855	855	855

Dimensions in mm. For guidance only. A dimensional drawing will be made upon request.

### Standard product range capacities (kW)

Type	EH-30					EH-35					EH-40										
Lube oil	33	37	40	45	48	51	59	63	74	78	96	100	111	116	121	132	139	145	152	159	166
Fuel oil	47	52	56	63	68	72	83	88	104	110	135	141	156	164	171	185	195	203	213	223	233

## Electronic thermostat

The Alfa Laval Aalborg thermostat type TC-E 8/4 is an electronic P-controller for use with electrical heaters.

The thermostat is based on a Pt100 sensor mounted in the electric heater and operates the up to 8 individual power relays.

The desired outlet temperature is programmed into the unit and the actual temperature is indicated on the display. Fluctuations in flow will result in changes in the measured temperature and thus the signal to the controller, which in turn will engage or disengage heating elements in the electrical heater.

The thermostat is very accurate and is used in applications where it is essential to maintain a constant temperature at all times.

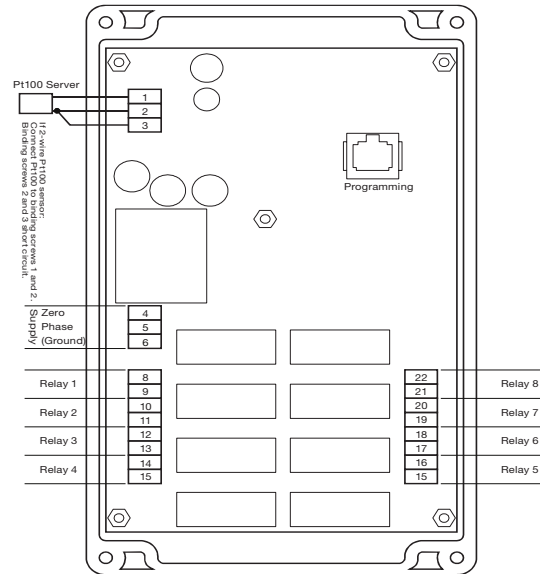

## Ordering key

Part No.	Number of steps	Size in mm (L x W x H)	Supply	Enclosure
56L1030	3, 4, 5, 6, 7 & 8	200 x 120 x 80	1 x 220/240 V - 50/60 Hz	IP56

## Technical data

### 56L1030 Electronic 3, 4, 5, 6, 7 & 8 steps

Range (°C)	0 to +200
Ambient temp. (°C)	-20 to +60
Hysteresis (°C)	+2.0
Min- temp. between each step (°C)	+1.0
Supply max. (volts/amperes)	250 VAC / 10 A
Cable entries	1 x PG13.5
Sensor	1 x Pt100 in stainless steel



## Control panel lamps indicate stepwise regulation



Contact your local Alfa Laval office

[www.alfalaval.com/contact-us](http://www.alfalaval.com/contact-us)

