

LIFTING LUGS ARE DELIVERED UNASSEMBLED

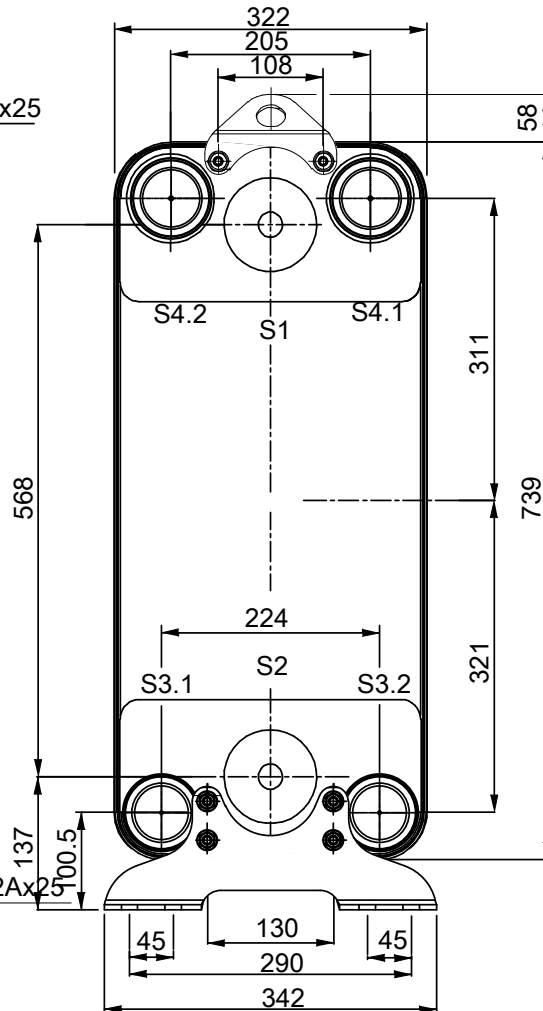

FEET ARE DELIVERED UNASSEMBLED

Diagonal flow type 6-ports:  
Circuit 1 :S3.1-S4.1  
Circuit 2 :S3.2-S4.2

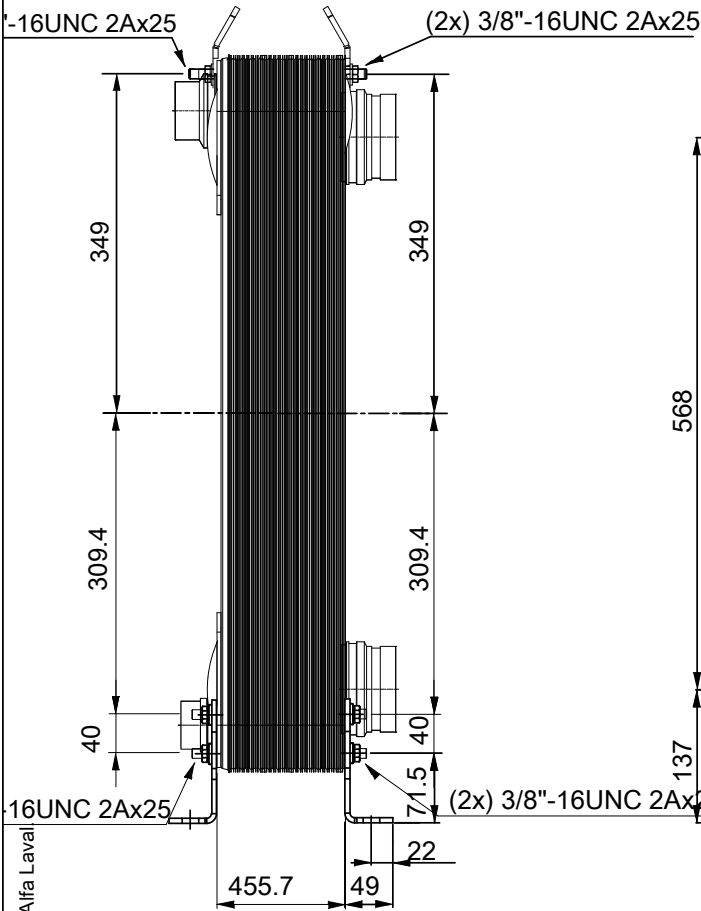
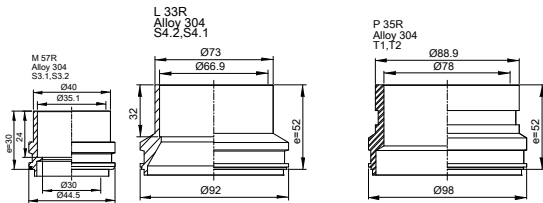
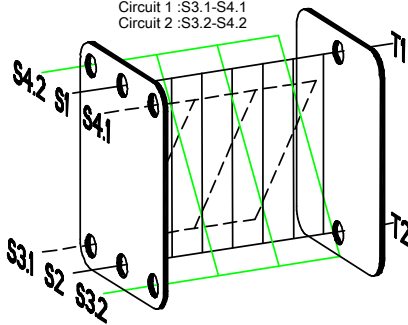

HEATING SURFACE  
NETWEIGHT 158.4 kg  
OPERATING WEIGHT kg  
PLATE MATERIAL ALLOY 316  
PLATE GROUPING 1\*42HR|1\*42HR|1\*85HR

T1 T2 T3.1 T3.2 T4.1 T4.2 locations on back side correspond to S1 S2 S3.1 S3.2 S4.1 S4.2 on front side

ALL DIMENSIONS IN MILLIMETERS

SIDE	MEDIA	INLET	TEMP.	OUTLET	TEMP.	FLOW RATE	PRESSURE DROP	LIQUID VOL.
1		S4.2, T2		S3.2, T1				40.0 dm <sup>3</sup>
2		S4.1		S3.1				21.0/21.0 dm <sup>3</sup>

Note that all unique customer requirements (i.e tolerance) need to be verified thru Alfa Laval

PRESSURE VESSEL APPROVAL

UL/CRN

ACH-500DQ-170H-F (3287084583)

www.alfalaval.com

CUSTOMER NAME / REF. NO.

COMPANY / REF.

TOTAL LENGTH 558.2 mm  
TOTAL WIDTH 322.0 mm  
TOTAL HEIGHT 838.0 mm

1/15/2024  
REV 0