

Note that all unique customer requirements (i.e tolerance) need to be verified thru Alfa Laval.

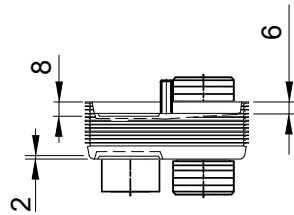
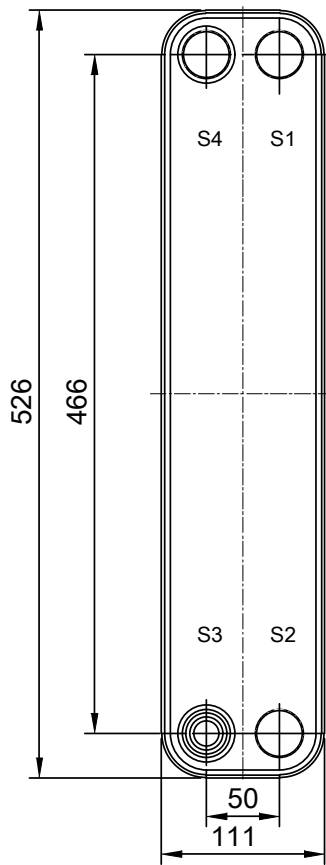
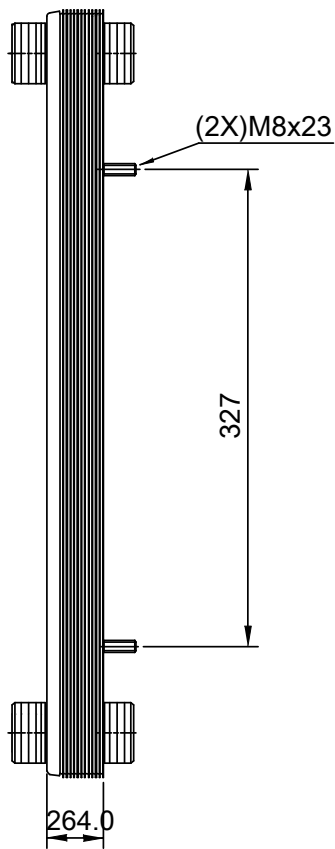
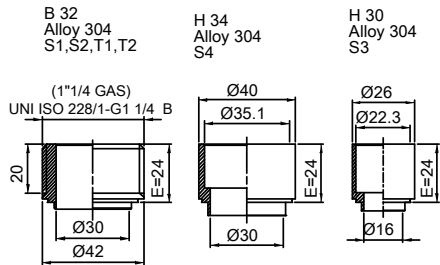

HEATING SURFACE  
 NETWEIGHT 22.3 kg  
 OPERATING WEIGHT kg  
 PLATE MATERIAL ALLOY 316  
 PLATE GROUPING 1\*54ML/1\*55MH

T1 T2 T3 T4 locations on back side correspond to S1 S2 S3 S4 on front side

ALL DIMENSIONS IN MILLIMETERS

| SIDE | MEDIA | INLET | TEMP. | OUTLET | TEMP. | FLOW RATE | PRESSURE DROP | LIQUID VOL.          |
|------|-------|-------|-------|--------|-------|-----------|---------------|----------------------|
| 1    |       | S1    |       | S2     |       |           |               | 5.23 dm <sup>3</sup> |
| 2    |       | S3    |       | S4     |       |           |               | 5.13 dm <sup>3</sup> |

PRESSURE VESSEL APPROVAL PED



AC-70X-110M-F (3287065808)

www.alfalaval.com

CUSTOMER NAME / REF. NO.

TOTAL LENGTH 306.0 mm  
 TOTAL WIDTH 111.0 mm  
 TOTAL HEIGHT 526.0 mm

COMPANY / REF.



4/16/2024  
 REV 0