

Alfa Laval Unique Sampling Valve - Accessories - Pressure Relief Valve

Sampling valves

Introduction

The Alfa Laval Pressure Relief Valve is a hygienic sampling accessory for overpressure protection when using the Alfa Laval Unique Sampling Valve. It controls steam pressure and temperature during sterilization of the valve. This safeguards your sampling valve and process lines against overpressure.

Application

This pressure relief valve for steam sterilization is designed for use during steam sterilization of the Unique Sampling Valve before and after taking representative samples from hygienic process lines across the food, beverage, personal care, pharmaceutical and many other industries.

Benefits

- Cost-effective, hygienic design
- Overpressure protection during Sterilization-in-Place
- Quick, thorough and safe steam sterilization
- Easy to clean

Standard design

This spring-loaded pressure relief valve for the Alfa Laval Unique Sampling Valve consists of a valve body, membrane seal, stem, spring, nozzle and handle. Constructed of insulating material for ease of handling during steam sterilization, it is positioned on the outlet of the sampling valve during Sterilization-in-Place.

Working principle

The Alfa Laval Pressure Relief Valve maintains the correct pressure and temperature during Sterilization-in-Place before and after taking representative samples. When using the pressure relief valve, sterilization typically takes place within two minutes using clean steam. The pressure relief valve is pre-set to a pressure of 2 bar, ensuring a temperature of 121°C, the recommended temperature for sterilization. Before taking a sample, pull the quick release handle to ensure that no steam pressure is present in the sampling valve, thereby ensuring operator safety.



TECHNICAL DATA

Temperature	
Temperature range:	1°C - 130°C
Max. sterilisation temperature, dry steam:	130°C

Pressure	
Max. working pressure:	600 kPa (6 bar)
Min. working pressure:	0 kPa (0 bar)

PHYSICAL DATA

Materials	
Steel parts:	1.4301 (304)
Other parts:	PA 6.6 30% GF
Membrane seal:	EPDM

Dimensions (mm)

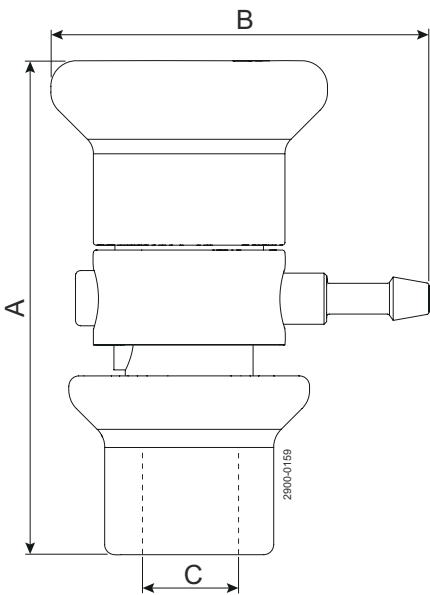

Figure 1. Size 4 and 10:

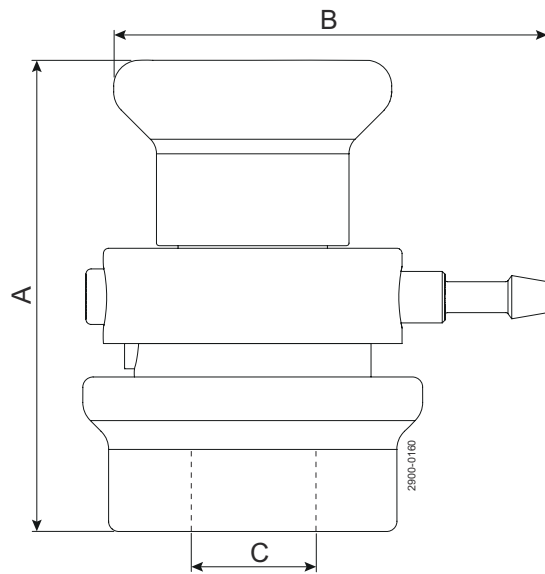

Figure 2. Size 25:

Size 4 and 10:			Size 25:		
A	B	C	A	B	C
96.5	70.7	14	91.5	90.3	30

This document and its contents are subject to copyrights and other intellectual property rights owned by Alfa Laval Corporate AB. No part of this document may be copied, re-produced or transmitted in any form or by any means, or for any purpose, without Alfa Laval Corporate AB's prior express written permission. Information and services provided in this document are made as a benefit and service to the user, and no representations or warranties are made about the accuracy or suitability of this information and these services for any purpose. All rights are reserved.

How to contact Alfa Laval

Up-to-date Alfa Laval contact details for all countries are always available on our website at www.alfalaval.com