

Note that all unique customer requirements (i.e tolerance) need to be verified thru Alfa Laval.

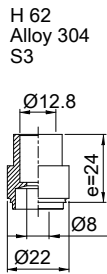

HEATING SURFACE  
 NETWEIGHT 4.6 kg  
 OPERATING WEIGHT kg  
 PLATE MATERIAL ALLOY 316  
 PLATE GROUPING 1\*19H/1\*20H

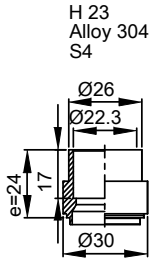
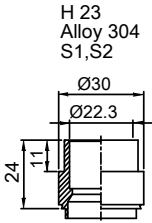
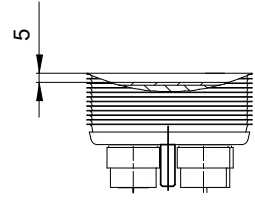
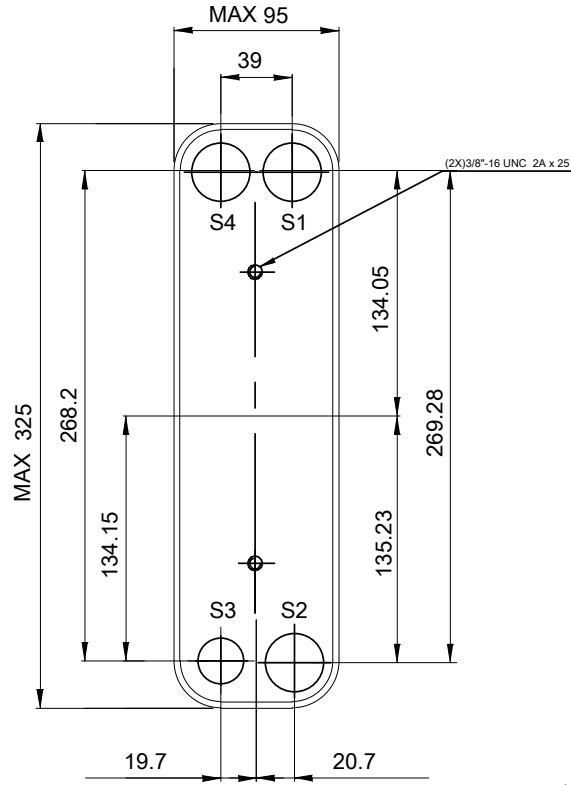

Frameplate is depressed 1.2 mm at connection S4  
 Pressureplate is depressed 1.2 mm / even number of channel plates at connections T4 / uneven number of channel plates at connections T1.  
 T1 T2 T3 T4 locations on back side correspond to S1 S2 S3 S4 on front side

ALL DIMENSIONS IN MILLIMETERS

SIDE	MEDIA	INLET	TEMP.	OUTLET	TEMP.	FLOW RATE	PRESSURE DROP	LIQUID VOL.
1		S1		S2				0.56 dm <sup>3</sup>
2		S3		S4				0.53 dm <sup>3</sup>



PRESSURE VESSEL APPROVAL UL/CRN  
 ACH-30EQ-40H-F (3287084896)

www.alfalaval.com

CUSTOMER NAME / REF. NO.	TOTAL LENGTH	95.8 mm
COMPANY / REF.	TOTAL WIDTH	94.0 mm
	TOTAL HEIGHT	323.0 mm
		1/15/2024 REV 0