

Note that all unique customer requirements (i.e tolerance) need to be verified thru Alfa Laval.

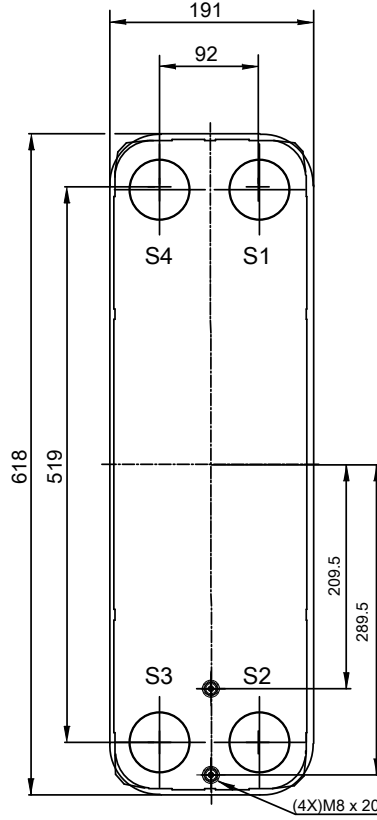
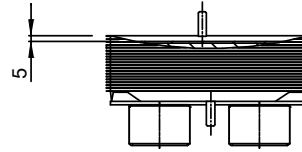
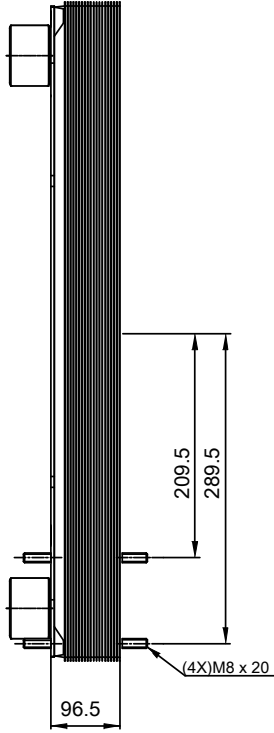
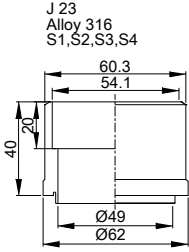

T1 T2 T3 T4 locations on back side correspond to S1 S2 S3 S4 on front side

HEATING SURFACE  
 NETWEIGHT 20.8 kg  
 OPERATING WEIGHT kg  
 PLATE MATERIAL ALLOY 316  
 PLATE GROUPING 1\*14H/1\*15H

ALL DIMENSIONS IN MILLIMETERS

SIDE	MEDIA	INLET	TEMP.	OUTLET	TEMP.	FLOW RATE	PRESSURE DROP	LIQUID VOL.
1		S1		S2				3.75 dm <sup>3</sup>
2		S3		S4				3.50 dm <sup>3</sup>

PRESSURE VESSEL APPROVAL

PED/UK



AlfaNova 76-30H (3287000849)

www.alfalaval.com

CUSTOMER NAME / REF. NO.

COMPANY / REF.

TOTAL LENGTH 151.5 mm  
 TOTAL WIDTH 191.0 mm  
 TOTAL HEIGHT 618.0 mm



4/16/2024  
 REV 0