

Note that all unique customer requirements (i.e tolerance) need to be verified thru Alfa Laval.

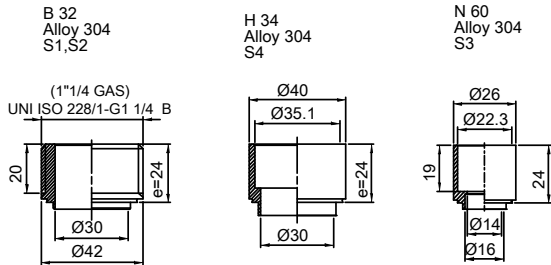

HEATING SURFACE
 NETWEIGHT 16.6 kg
 OPERATING WEIGHT kg
 PLATE MATERIAL ALLOY 316
 PLATE GROUPING 1*39ML/1*40MH

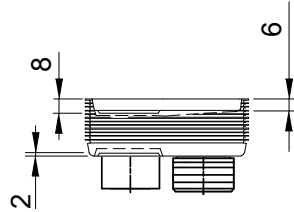
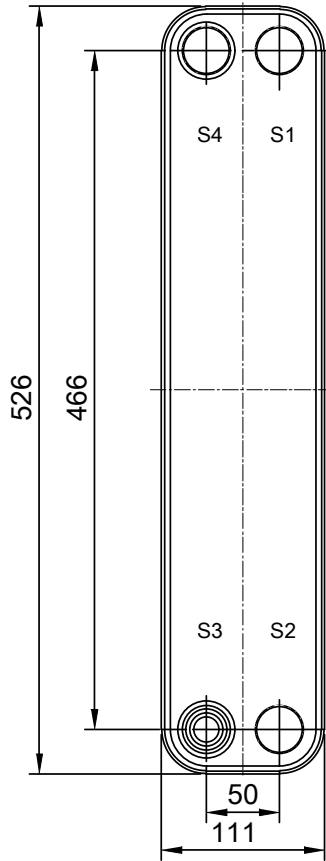
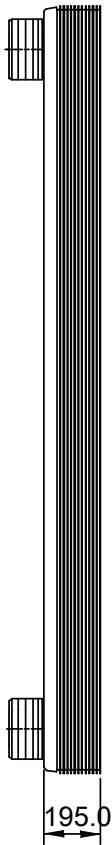

T1 T2 T3 T4 locations on back side correspond to S1 S2 S3 S4 on front side

ALL DIMENSIONS IN MILLIMETERS

| SIDE | MEDIA | INLET | TEMP. | OUTLET | TEMP. | FLOW RATE | PRESSURE DROP | LIQUID VOL. |
|------|-------|-------|-------|--------|-------|-----------|---------------|----------------------|
| 1 | | S1 | | S2 | | | | 3.80 dm ³ |
| 2 | | S3 | | S4 | | | | 3.71 dm ³ |

PRESSURE VESSEL APPROVAL PED



AC-70X-80M-F (3287065793)

www.alfalaval.com

CUSTOMER NAME / REF. NO.

TOTAL LENGTH 219.0 mm
 TOTAL WIDTH 111.0 mm
 TOTAL HEIGHT 526.0 mm

COMPANY / REF.



1/15/2024
 REV 0